

# Basic 210

Some examples of applications:

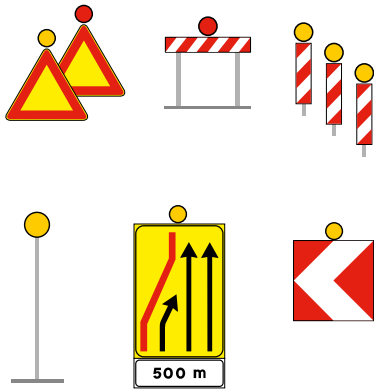

## Adapter for Ø40 mm panels

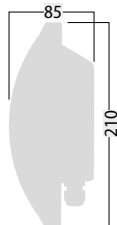

Basic 210 is a LED warning light for temporary use. It is available in different models and it is suitable for all the applications where there is a need to warn, inform or guide road users.

Certification	<b>EN12352 L8H - L8M</b>
Input voltage	<b>12/24 VDC</b>
LED colour	<span style="color: yellow;">●</span> <span style="color: red;">●</span> <span style="color: green;">●</span>
Max. power consumption	<b>6 W</b>
Dimensions	<b>Ø 210 x 85 mm</b>

Flashing	Power cons. @12V	
Flash LED (10%)	<b>1.2 Ah</b>	/day
Tri Flash (5%+5%+5%)	<b>1.8 Ah</b>	/day
Single (50%)	<b>6 Ah</b>	/day
Steady	<b>12 Ah</b>	/day